



PREAMBLE

This Technical User Guide contains warnings and guidance for correct and safe operation of the product. These instructions must be followed at all times. TPL Vision will not be held responsible for problems caused by using the product contrary to these instructions and the Warranty will be deemed invalid.



UNPACKING

Products are packed in our factory, using suitable materials for a safe transport through the usual means of transportation, in France and internationally. However, a damaged package must be reported to the carrier on delivery. Hand-written reservations must be indicated on the delivery order. Moreover, please send a letter or an email to TPL Vision as soon as possible (up to 24 hours after the delivery). If the transportation damage has not been stipulated on the delivery order and reported to TPL Vision in time, the package will not be taken back nor exchanged. To open the package, do not use any cutting blade to avoid damaging the product(s). Please use the delivered accessories, if needed (do not use any other products or equivalents to replace the delivered accessories).

RISK CLASS

The EN-62471 norm about lighting fluxes enables the classification of led lightings in 4 distinct groups, according to their hazardousness degree. Please find below an indicative table, recapitulating the classes of risk for our standard products.

Colour	Class	Risk
White WHI, Green 525 nm, Red 630 nm	0	none
UV 405 nm, Blue 470 nm, IR 850 nm	1	low
UV 365 nm	2	moderate
UV 385 nm	3	high

In all cases, TPL Vision recommends the use of **the protection glasses** that are listed in its catalog.

For more information about photo-biological risks, do not hesitate to contact us.

TPL Vision can provide guidance notes about the **nominal distance to minimize eye risks**.



BEWARE to the infrared light, invisible to the eyes.

To know if the light is on, please refer to the LED indicators.



FLOOD LIGHT USER GUIDE

P2/8

■ DIMENSIONS

	Length (mm)	Width (mm)	Height (mm)	Height with fixing plate (mm)	Diameter of central hole (mm)
	A	B	C	C + 10	D
FLOOD Light 30x20	300	200	45	55	65
FLOOD Light 60x30	600	300	45	55	65

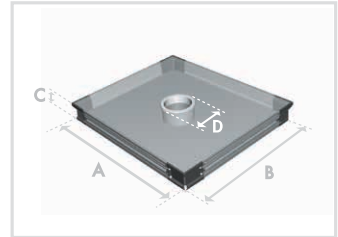

- **Useful surface:** A x B
- **Total surface:** (A + (4mm x 2)) x (B + (4mm x 2))
(connector excluded)

■ FIXING ON THE MACHINE

During the set up, the light has to be switched off and unplugged. Please use the fixing groove or holes designed for that purpose. We recommend the using of nuts (supplied) in the groove or M4 screws (not supplied) with a tightening torque from 0.5 to 1.5 Nm. We also recommend the use of a threadlocker (not supplied) to avoid any risk of loosening.

FIXING ON THE LENGTH (groove)

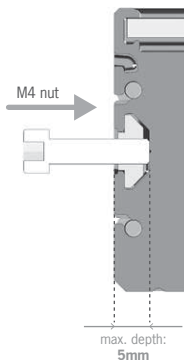

(4 M4 nuts – supplied)

FIXING ON THE CORNER

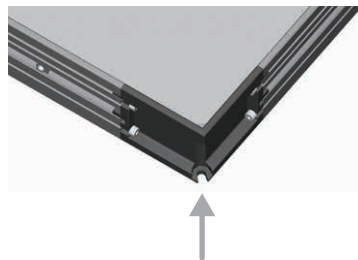

(CHC screw M4x20 – not supplied)



⚠ BE CAREFUL WHEN USING ANGLE BRACKETS (TPL Vision ref: TPL-MOUNT-HPB-SQUARE1).

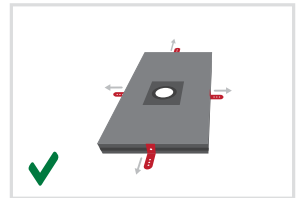
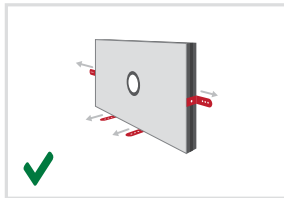
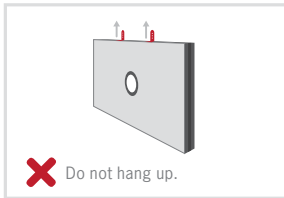

■ CAMERA FIXING

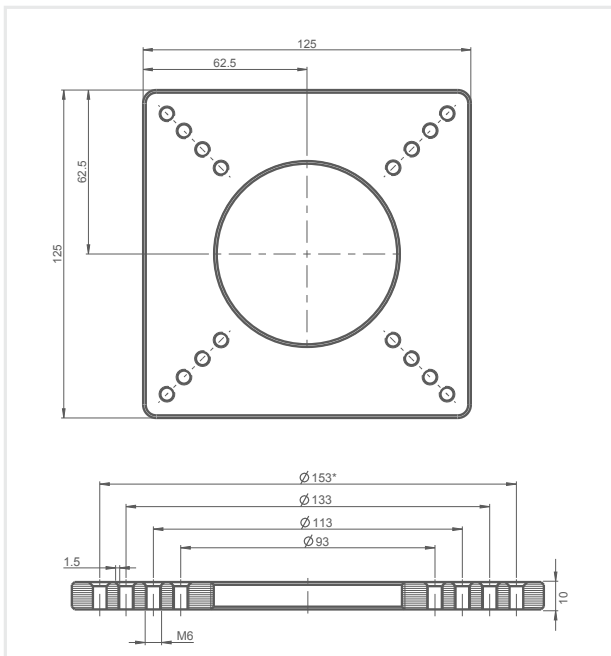

Length:	125 mm
Width:	125 mm
Height:	10 mm
Screw:	M6

TPL Vision also offer 2 types of mounting accessories for cameras:

- TPL-MOUNT-HPFD-V1
- TPL-MOUNT-HPFD-H1

Get more info on our website:

mount.tpl-vision.com



FLOOD LIGHT USER GUIDE

LED INDICATORS & POTENTIOMETER

Strobe
LED indicator

Power
LED indicator



Singleturn potentiometer 30%-100%
(use a flat-head screwdriver 2.4 mm)

! WARNING: FRAGILE
Handle with care

! WARNING: in continuous mode, set the potentiometer at the minimum (30%).

CONNECTION

M12 Connector 4 male points

POWER CONNECTOR - T CODING

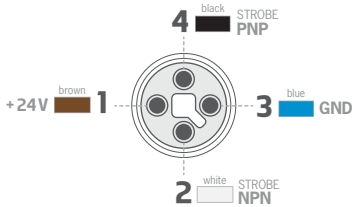

STROBE :

PNP : from 5 to 24V for 100% ON. From 0 to 1V for 100% OFF.
NPN : less than 1V for 100% ON. Above 2V for 100% OFF. Max 20V.

STROBE PNP :



STROBE NPN :



Voltage drop for Connector M12 + wire 10 meters:
(Minimum Voltage at the product input: 20VDC)

1.15V @ 5A

2.3V @ 10A

3.5V @ 15A

4.6V @ 20A

MAX 20A

POTENTIOMETER SETTING

- Lowest level of the potentiometer: 30% of the power.
- Highest level of the potentiometer: 100% of the power.



When the product is delivered, the potentiometer is set at 30%. To use it in Overdrive when the potentiometer is set at 100%, you must **absolutely respect** a maximum lighting time of 3ms and a maximum duty cycle of 10%.



■ TECHNICAL INFORMATION

FEATURES	FLOOD Light
Consumption	3W/25cm ² in peak max 0,43W/25cm ² max on average (3ms@10%)
Min. functioning Voltage	20V in the light input
Normal functioning Voltage	24V in the light input (±10%)
Max. functioning Voltage	30V in the light input
Max. consumption Strobe signal	5mA
Operating temperature	-10° to +40°C / 80% of humidity without condensation No thermal shock (max temperature variation: 10°C in 24h)

■ USER SECURITY

**Please respect the power supply voltages and the connection terminals.
Do not modify or dismantle all or part of the product.
Do not connect or clean when power is on.
Do not watch the lighting source directly, and follow the advice below :**



- If the workstation enables it, interpose a filter that will stop the lighting radiation under fixed or adjustable frame between the source and the operator.
- When these measures cannot be implemented, supply the operators with glasses (class 4) available for sale at TPL Vision.
- Forbid or limit the direct access to the lighting source (exposure into the radiation axis).
- Establish a security perimeter so as to prevent the operators from approaching the lighting source beyond the recommendations of the manufacturer, where eye irritation is concerned.
- Ensure that the chosen means properly reduce the exposure level (e.g. features of screens or glasses to be chosen, according to the wavelengths that the operators are exposed to).

■ EQUIPMENT MAINTENANCE

CLEANING (when the product is switched off)

Please use a soft and dry cloth. Do not use any abrasive material.
Do not use any cleaning solvent or aggressive chemical product.
TPL Vision recommends to use isopropyl alcohol.

■ OPERATING CONDITIONS

Not for outdoor use.



Brenchley House, School Road
Charing, Kent TN27 0JW
United Kingdom

+44 (0)1738 310 392

contact@tpl-vision.co.uk

TPL VISION
IS AN **ISO 9001**
CERTIFIED MANUFACTURER

www.tpl-vision.com